

VCM-SF/EG4-10

Combination Pump-Vane + Gear

組合幫浦
定量葉片幫浦+外齒輪幫浦

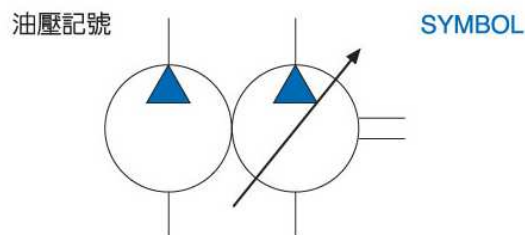

型式號碼 / Model Code

VCM-SF-30-A/EG4-10-4.3

	齒輪幫浦流量	Displacement of Gear Pump
	齒輪幫浦系列號碼	Gear Pump Series No.
	壓力	Pressure
	A:20kgf/cm ² , B:35kgf/cm ²	C:55kgf/cm ² D:70kgf/cm ²
	葉片幫浦流量	Displacement of Vane pump at 1800rpm
	30L,40L	
	系列號碼:	Series No
	葉片幫浦系列	Vane Pump Series

產品特性

1. 結合高低壓幫浦的特性，具備高低壓力並用的功能。
2. 葉片幫浦省能源，低噪音平穩的特性，搭配齒輪幫浦高效率的性能，是工程師在系統設計時優良的選擇。
3. 節省體積，縮小機械空間，節省能源。
4. 性能優異的齒輪幫浦可作為高壓幫浦或系統冷卻之用。
5. 標準法蘭安裝及維護容易。
6. 性能參數請參考相關之各別幫浦。

FEATURE

1. Combine the characteristics of both high and low pressure pumps, applicable to for high-low pressure system.
2. Power saving, low noise and smooth operation. Best choice for hydraulic system design for engineer.
3. Compactness, minimize space and energy saving.
4. Excellent performance gear pump could be used as a high pressure source or use as cooling system.
5. SAE standard flange.
6. Please refer to the table of single pump for performance figure.



Camel Hydraulics

Page E9

Combination Pump-Vane + Gear

組合幫浦
定量葉片幫浦+外齒輪幫浦

技術資料 / Technical Data

型式 MODEL	低壓葉片幫浦 Vane Pump		高壓齒輪幫浦 Gear Pump		容許迴轉速 Shaft Speed rpm		重量 Weight Kg
	理論流量 Theoretical Displacement cm ³ /rev	最高壓力 Max Pressure kgf/cm ²	理論流量 Theoretical Displacement cm ³ /rev	最高壓力 Max Pressure kgf/cm ²	Max	Min	
					Max	Min	
SF-30A/EG4-10-*	16.7	20	Refer to single external gear pump	Suggestion 190 kgf/cm ²	1800	800	10.4kgs +EG pump
SF-30B/EG4-10-*		35			1800	800	
SF-30C/EG4-10-*		55			1800	800	
SF-30D/EG4-10-*		70			1800	800	
SF-40A/EG4-10-*	22.2	20	Refer to single external gear pump	Suggestion 190 kgf/cm ²	1800	800	
SF-40B/EG4-10-*		35			1800	800	
SF-40C/EG4-10-*		55			1800	800	
SF-40D/EG4-10-*		70			1800	800	

尺寸圖 / Dimension

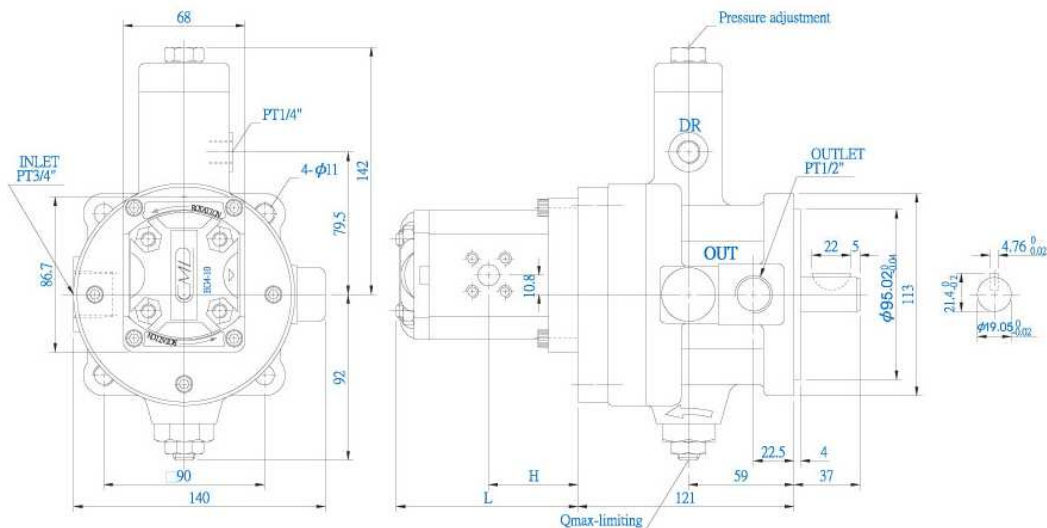

齒輪幫浦 / EG4-10 Series		1.2 c.c	1.7 c.c	2.2 c.c	2.6 c.c	3.2 c.c	3.8 c.c	4.3 c.c	6.2 c.c	7.8 c.c
尺寸 Dimension mm	H	37.8	38.5	39.5	40.5	41.5	42.5	43.5	47	50
	L	75.5	77	79	81	83	85	87	94	100
重量 / Weight	kgs	1.0	1.0	1.0	1.1	1.1	1.2	1.2	1.3	1.4