

# TECHNICAL SPECIFICATIONS

## BM70

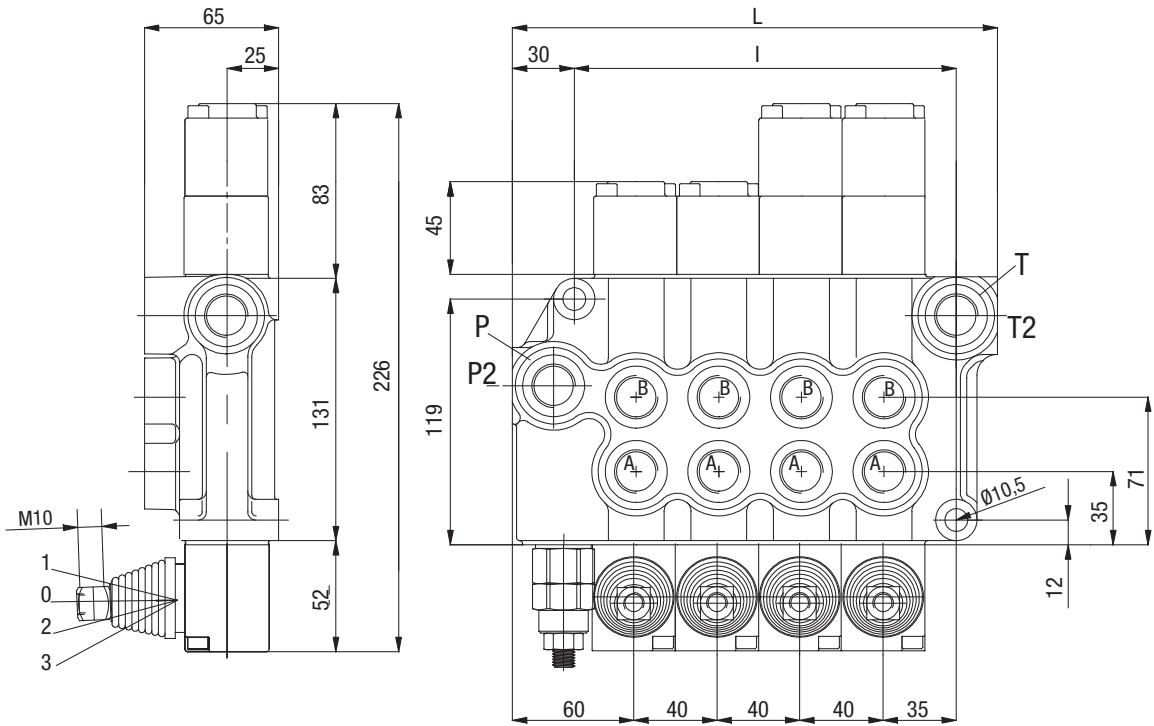

### TECHNICAL CHARACTERISTICS

NOMINAL FLOW	70 l/min	18.5 GPM
MAX FLOW	80 l/min	21,5 GPM
MAX FLOW - Electrical control	60 l/min	16 GPM
NOMINAL PRESSURE	250 bar	3600 PSI
MAX PRESSURE ON PORTS	320 bar	4700 PSI
MAX PRESSURE ON PORTS - Electrical control	160 bar	2300 PSI
MAX PRESSURE ON TANK-LINE	80 bar	1100 PSI

### STANDARD THREADS

	A - B	P	T	P2	T2
G (BSP)	1/2"	1/2"	1/2"	3/4"	3/4"
F (UNF)	7/8" -14	7/8" -14	7/8" -14	1.1/16" -12	1.1/16" -12

### INTERNAL OIL LEAKAGE

A - B → T	4 ÷ 8 cc/min
-----------	--------------

### TESTING CONDITIONS

PRESSURE	100 bar
OIL TEMPERATURE	40 °C
OIL VISCOSITY	32 mm <sup>2</sup> /s

### STANDARD THREADS

NUMBER OF SECTIONS	L		I		kg	lb
	(mm)	(inch)	(mm)	(inch)		
BM70/1	115	4.52	65	2.55	4.5	9.1
BM70/2	155	6.1	105	4.13	7.4	16.5
BM70/3	195	7.67	145	5.7	9.9	21.1
BM70/4	235	9.25	185	7.28	11.4	25.2
BM70/5	275	10.8	225	8.85	13.6	29.2
BM70/6	315	12.4	265	10.43	16	35.4

### PRESSURE DROP

P → T

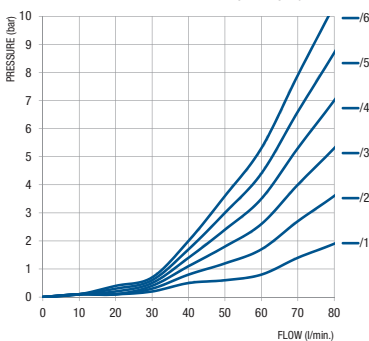
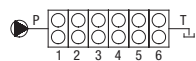

P → A/B

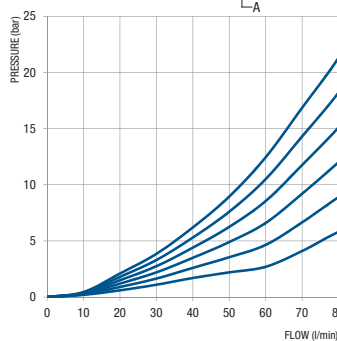
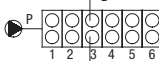

A/B → T

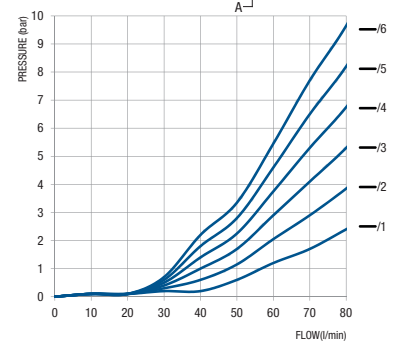
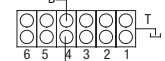

# TECHNICAL SPECIFICATIONS

## BM100

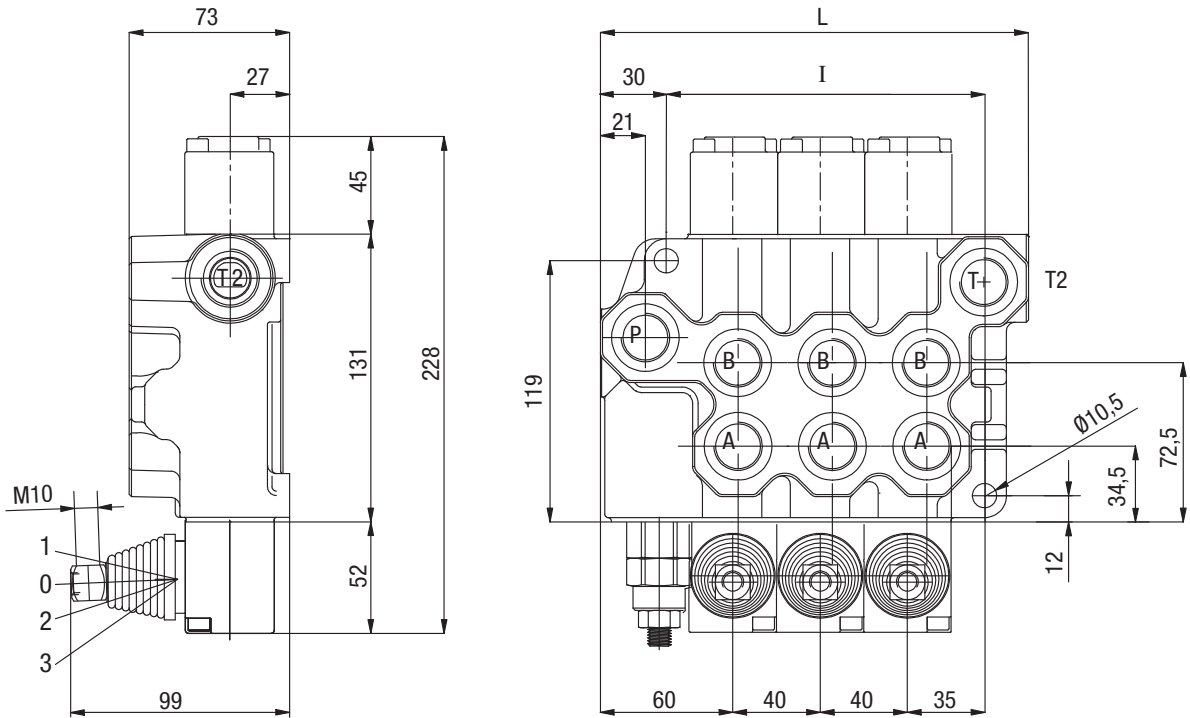

### TECHNICAL CHARACTERISTICS

NOMINAL FLOW	90 l/min	24 GPM
MAX FLOW	100 l/min	26 GPM
MAX FLOW - Electrical control	60 l/min	26 GPM
NOMINAL PRESSURE	250 bar	3600 PSI
MAX PRESSURE ON PORTS	320 bar	4700 PSI
MAX PRESSURE ON PORTS - Electrical control	160 bar	2300 PSI
MAX PRESSURE ON TANK-LINE	80 bar	1100 PSI

### STANDARD THREADS

	A - B	P	T	P2	T2
G (BSP)	3/4"	3/4"	3/4"	3/4"	3/4"
F (UNF)	1.1/16"-12	1.1/16"-12	1.1/16"-12	1.1/16"-12	1.1/16"-12

### INTERNAL OIL LEAKAGE

A - B → T	4 ÷ 8 cc/min
-----------	--------------

### TESTING CONDITIONS

PRESSURE	100 bar
OIL TEMPERATURE	40 °C
OIL VISCOSITY	32 mm <sup>2</sup> /s

### STANDARD THREADS

NUMBER OF SECTIONS	L (mm)	L (inch)	I (mm)	I (inch)	kg	lb
BM100/1	115	4.52	65	2.55	4.5	9.1
BM100/2	155	6.1	105	4.13	7.4	16.5
BM100/3	195	7.67	145	5.7	9.9	21.1

### PRESSURE DROP

P → T

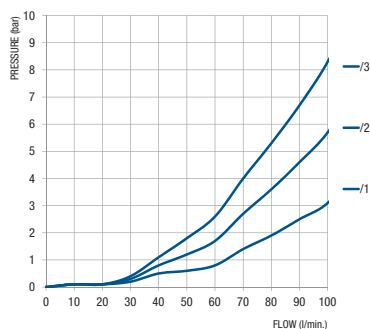
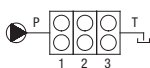

P → A/B

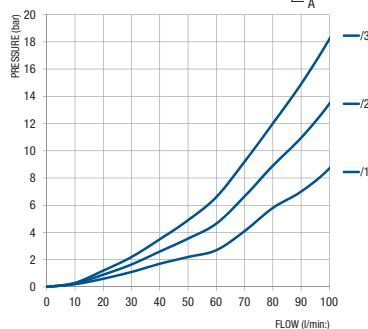
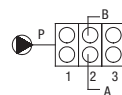

A/B → T

